

Assembly Instructions:

M1 Performance Anchor



Package Contents:

- ♦ Anchor Fluke
- ♦ Shank
- ♦ Roll Bar
- ♦ 6 Bolts (4 Shank Bolts, 2 Rollbar Bolts), 6 Nuts, 6 Spring Washers
- ♦ Lanolin lubricant

Insert bolts from the bottom, apply lubricant to threads liberally

Assemble as in the diagram below (there is no specific torque setting, tighten until the spring washer is flattened).

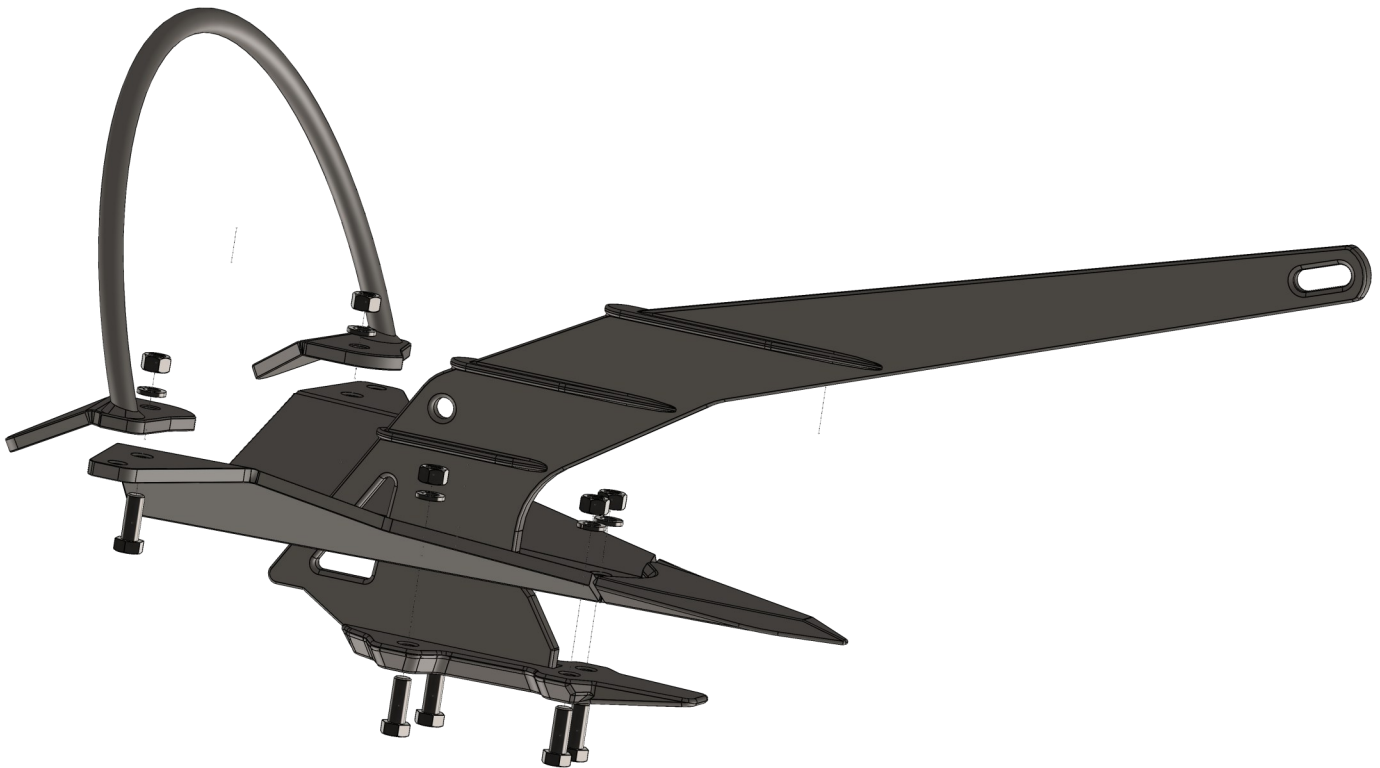

If you are missing any parts or require any assistance please call us at 1-(855)- 262-6887 or email us info@mantusmarine.com